



BELGARD®
PAVES THE WAY™

T-BLOCK



**RECTANGULAR
PLANTER**

T-BLOCK

COMPLETE THIS STEP
FIRST FOR ALL PROJECTS

BASE PREPARATION

Always level ground before installation

ON NEW OR EXISTING PATIO

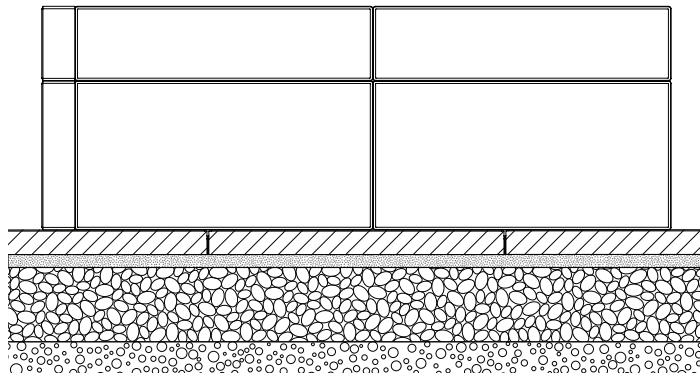

SLAB OR PAVER

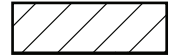

BEDDING SAND 1"

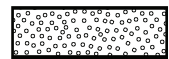

COMPACTED AGGREGATES 6"-8"



SOIL

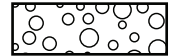

ON POURED CONCRETE

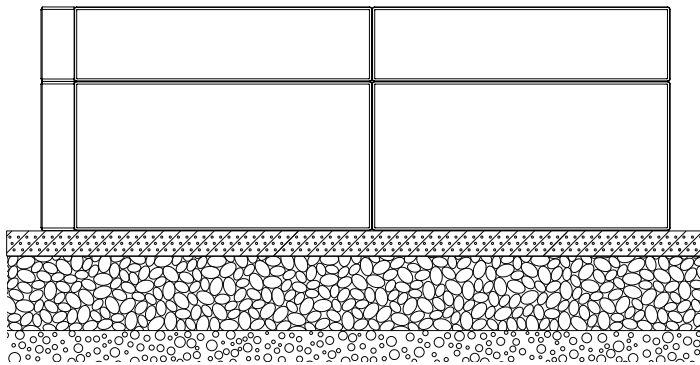

REINFORCED POURED CONCRETE FOUNDATION 2"

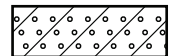

COMPACTED AGGREGATES 6"-8"



SOIL



ON COMPACTED FOUNDATION

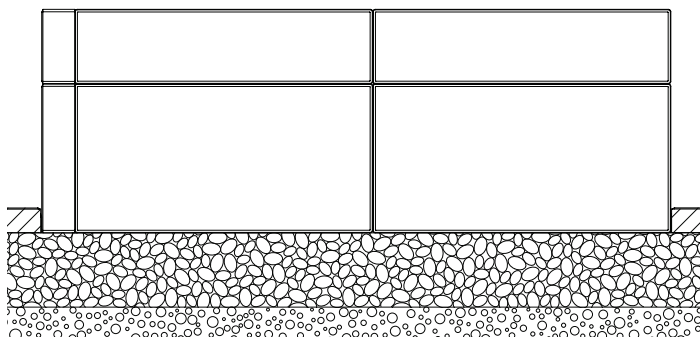

SLAB OR PAVER



COMPACTED AGGREGATES 6"-8"



SOIL

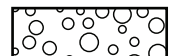

T-BLOCK

RECTANGULAR PLANTER

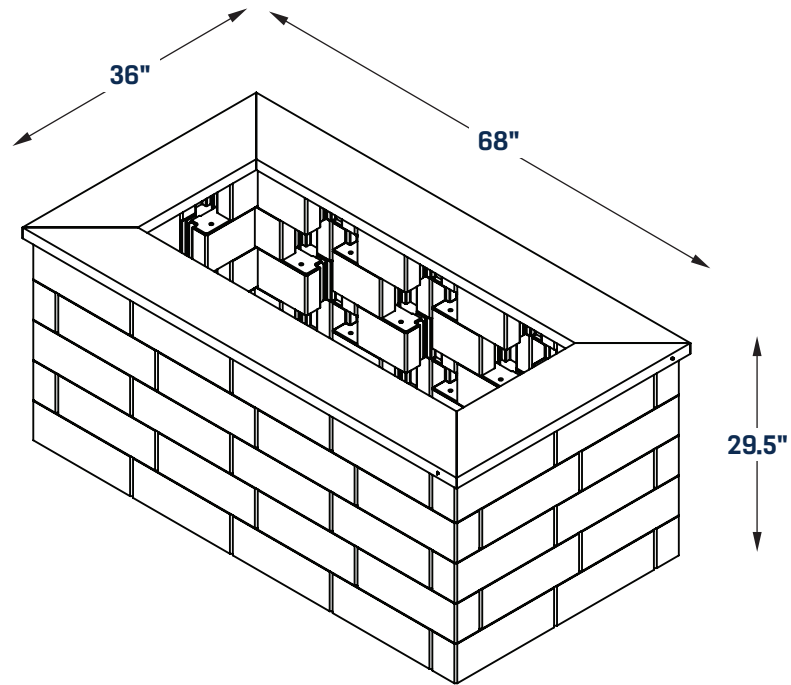

COMPONENTS

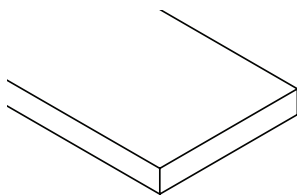

2" x 10" x 8' (x3)

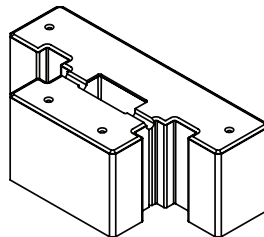

T-Block (x60)



Glue Tube



No.8 x 3" (x4)

T-BLOCK

RECTANGULAR PLANTER

REQUIRED TOOLS

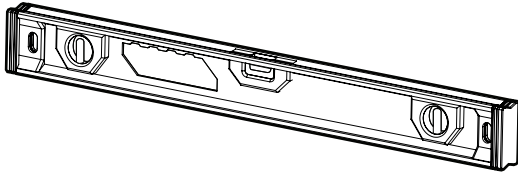

LEVEL

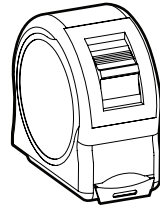

**MEASURING
TAPE**

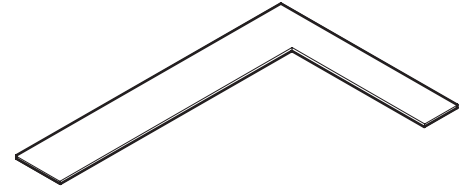

**CARPENTER
SQUARE**

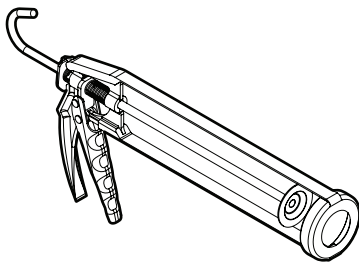

**SILICONE
GUN**

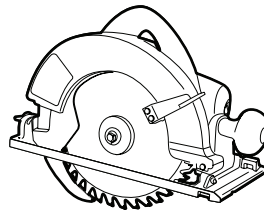

SKILLSAW

SAFETY EQUIPMENT



SAFETY BOOTS

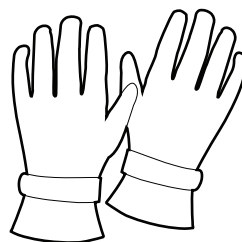

GLOVES

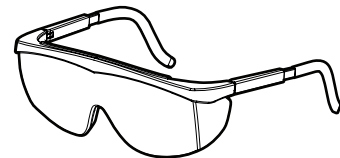

SAFETY GLASSES

T-BLOCK

RECTANGULAR PLANTER

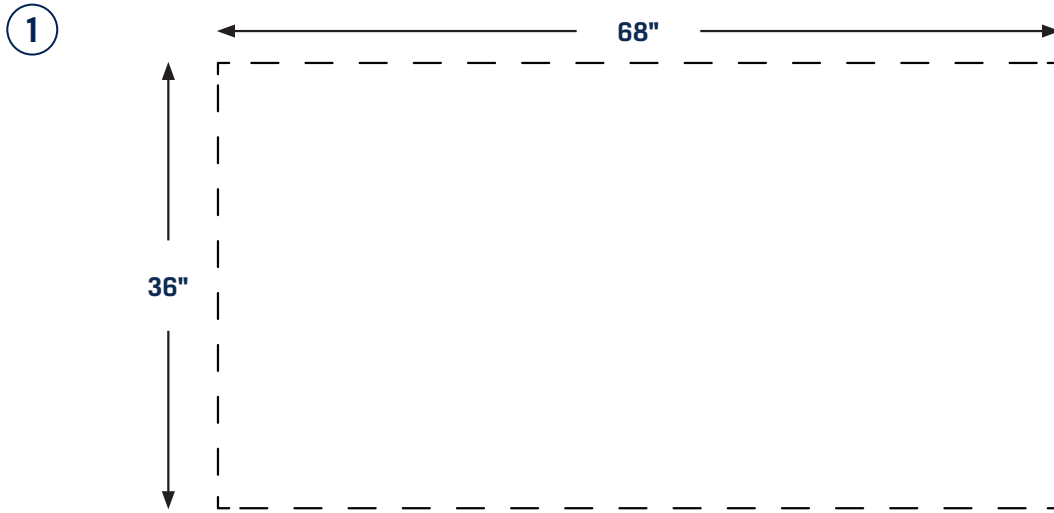

- ② Do not forget to add glue in the cavities before laying down your next level.

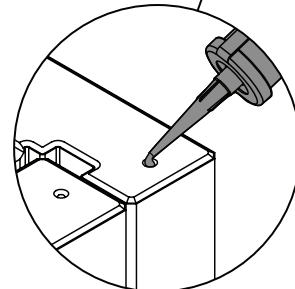
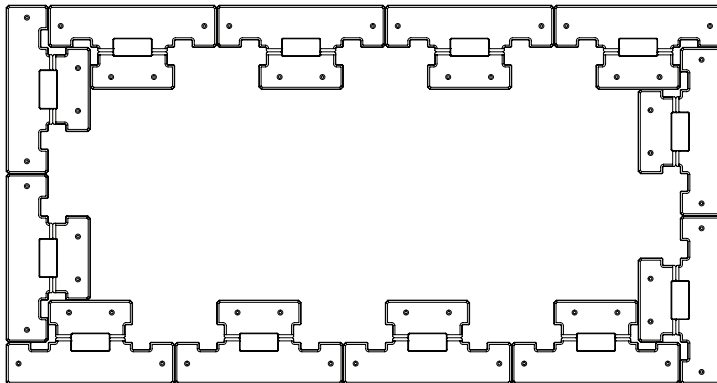
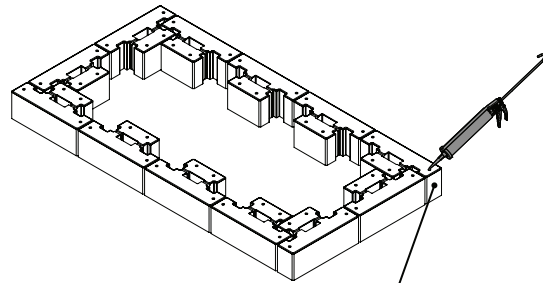

T-BLOCK

RECTANGULAR PLANTER

- 3 Do not forget to add glue in the cavities before laying down your next level.

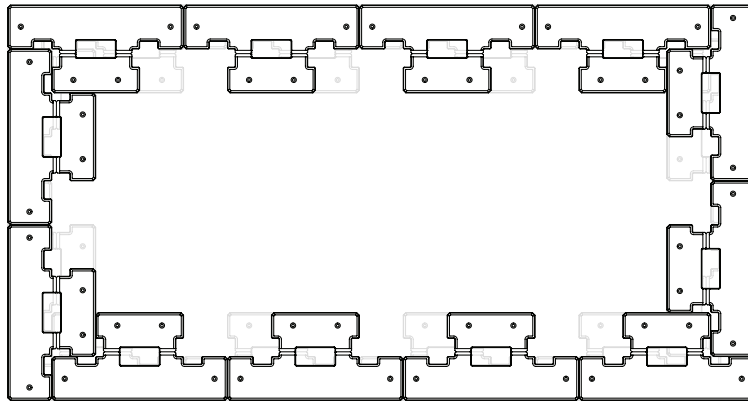
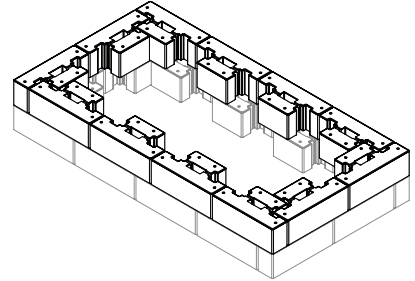

- 4 Continue alternating steps 2 and 3 until you have 5 levels. Don't forget to add glue in the cavities before each new level.

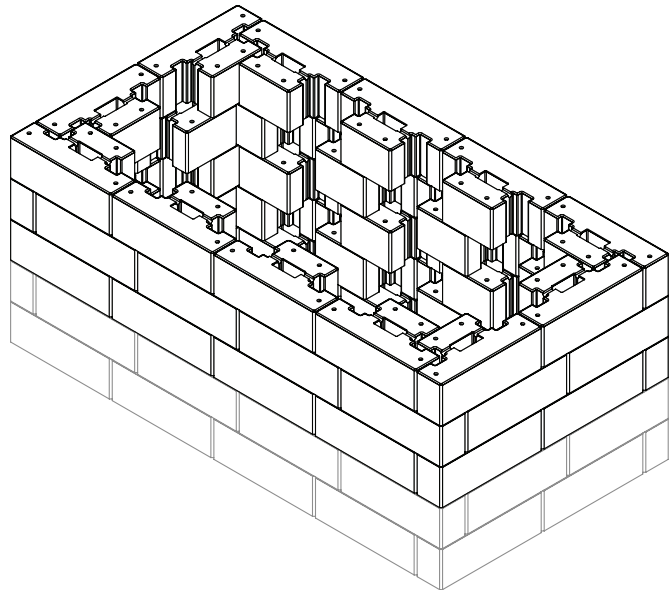

T-BLOCK

RECTANGULAR PLANTER

WOOD CUTS

□ 2" x 10" x 8'

A = 69¼"

B = 37¼"

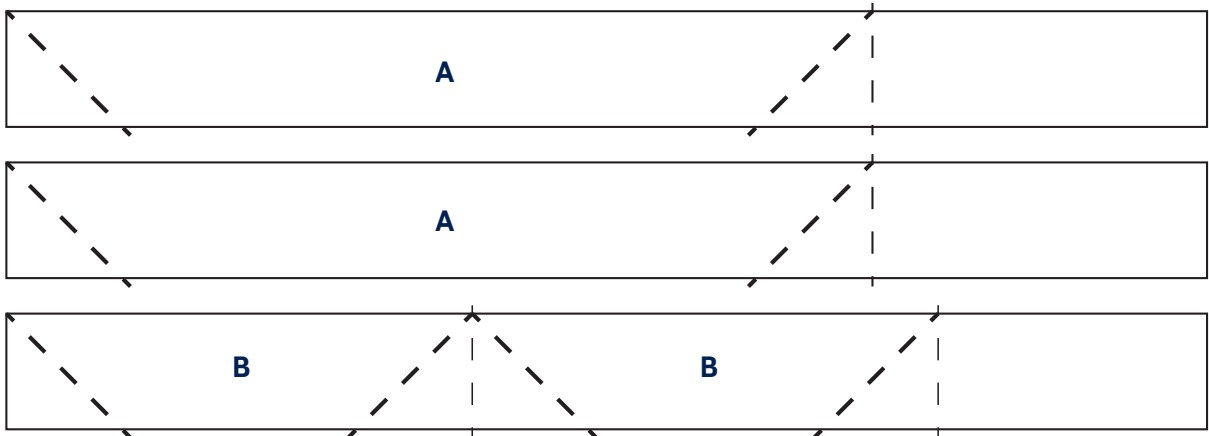
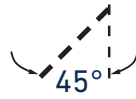

- 5 Put the angle pieces together to create the frame shape, keeping all edges aligned while the glue sets.

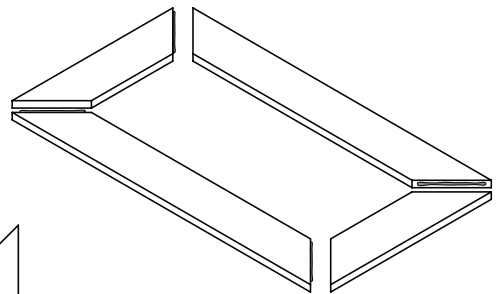
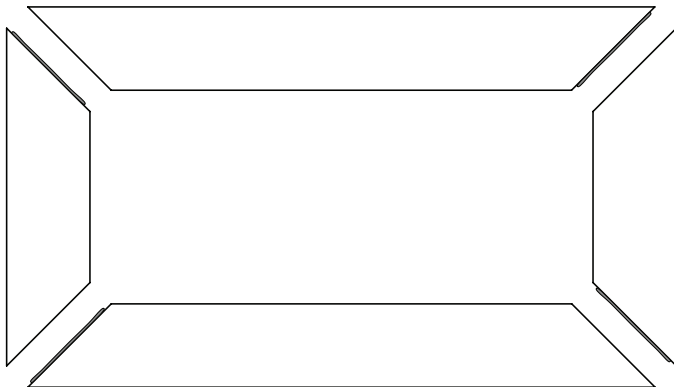

T-BLOCK

RECTANGULAR PLANTER

- 6 Add the screws in each corner, making sure they go through the middle of the boards for a solid connection.

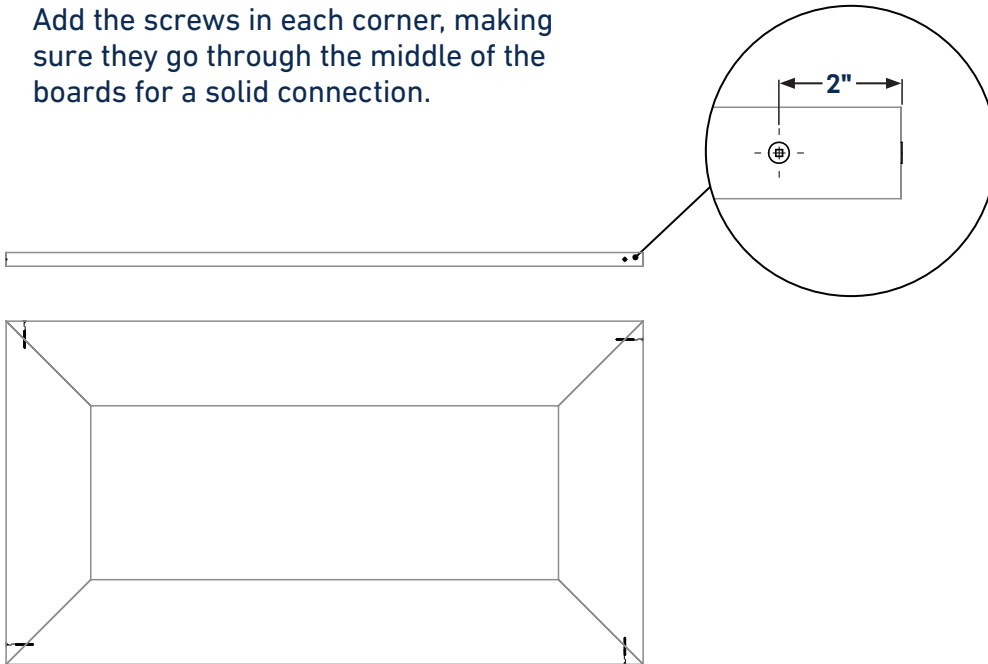

- 7 Do not forget to add glue in the cavities before laying down the frame.

