

# 6. LONG BBQ

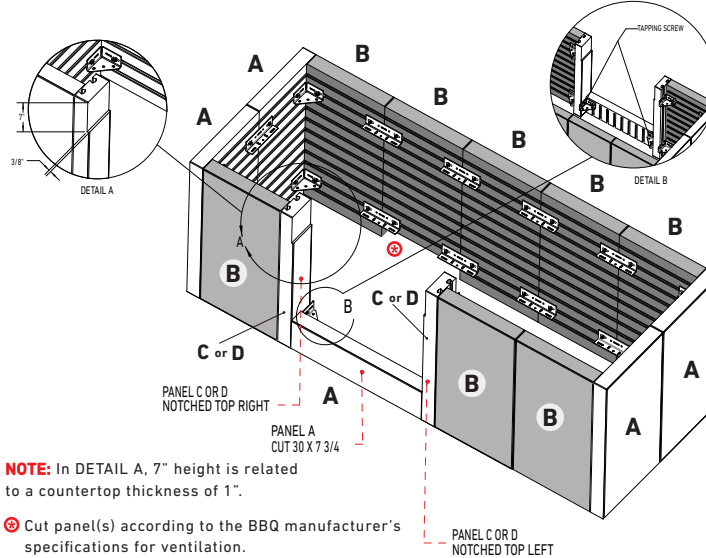

## INTERIOR VIEW



**NOTE:** In DETAIL A, 7" height is related to a countertop thickness of 1".

⊕ Cut panel(s) according to the BBQ manufacturer's specifications for ventilation.

**NOTE:** Panels "B" can be replaced with panels "A" to equilibrate the pairs/layers. Panels "A" can't be replaced by the panels "B".

## FRONT VIEW

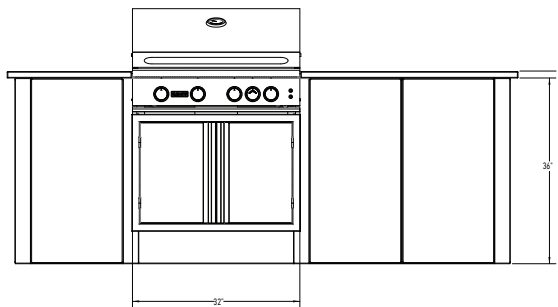

## TOP VIEW

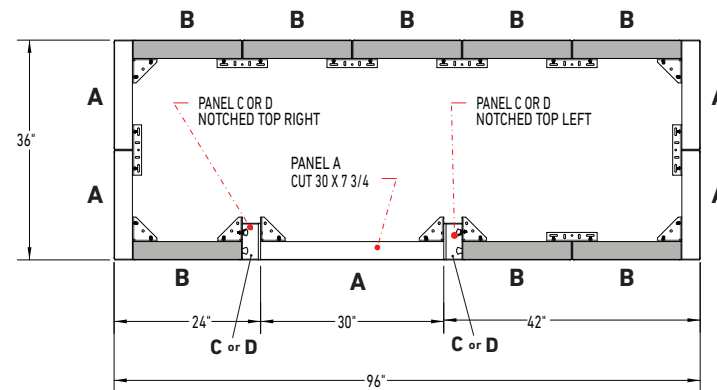

## REQUIRED PANELS

	5x
	8x
	2x
	0x

**IMPORTANT:** 18 x 36 panels are sold in pair/layer or in full pallet only. 6 x 36 panels are sold per unit or in layer or in full pallet.

## REQUIRED HARDWARE

	56x
	14x
	14x
	0x
	0x

**TOTAL WEIGHT** 1956 Lbs  
(PANELS & HARDWARE)

**IMPORTANT:** It is recommended to follow the BBQ manufacturer's specifications for ventilation and clearances. Belgard is not responsible for the conformity of connections, clearances and ventilation. BBQ, countertop and accessories are not included.