

## PARTS LIST - HARDWARE (STAINLESS STEEL)

### **Anchor Slide – 1/4" x 20 stud & nut**

2 x 1 1/4 x 1" (51 x 33 x 25 mm)  
100 units/box

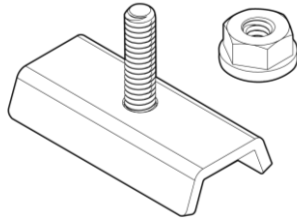

### **\*Joining Plate**

8 1/4 x 2 1/2 x 1 1/2" (209 x 63 x 38 mm)  
40 units/box

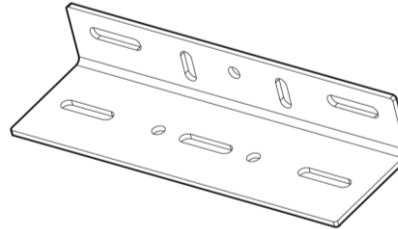

### **\*Inner Corner**

9 x 6 x 2 1/2" (232 x 155 x 63 mm)  
24 units/box

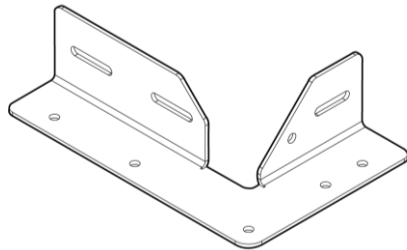

### **\*Outer Corner**

4 x 4 x 2 1/2" (101 x 101 x 63 mm)  
48 units/box

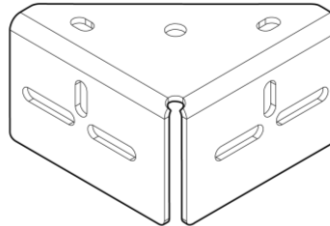

### **\*Stretcher Bar**

36 3/4 x 1 1/4 x 1" (933 x 33 x 25 mm)  
10 units/box

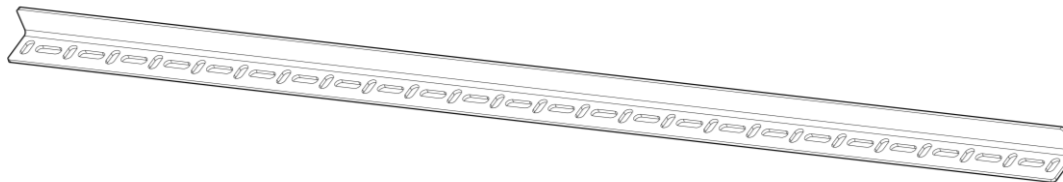

\* **NOTE:** Can be sold separately.