

**NOTE:**  
 IN THE "CROSS-OVER AREA" OF REINFORCEMENT, ONE OF THE LAYERS OF REINFORCEMENT SHOULD BE LOWERED OR RAISED ONE COURSE TO ALLOW PLACEMENT OF THE REINFORCEMENT WITH THE PRINCIPLE REINFORCEMENT STRENGTH DIRECTION PROPERLY ORIENTATED. THE REINFORCEMENT SHOULD NOT EXTEND INTO THE SEGMENTAL RETAINING WALL UNITS ON THE RETURN LEG OF THE 90-DEGREE CORNER.

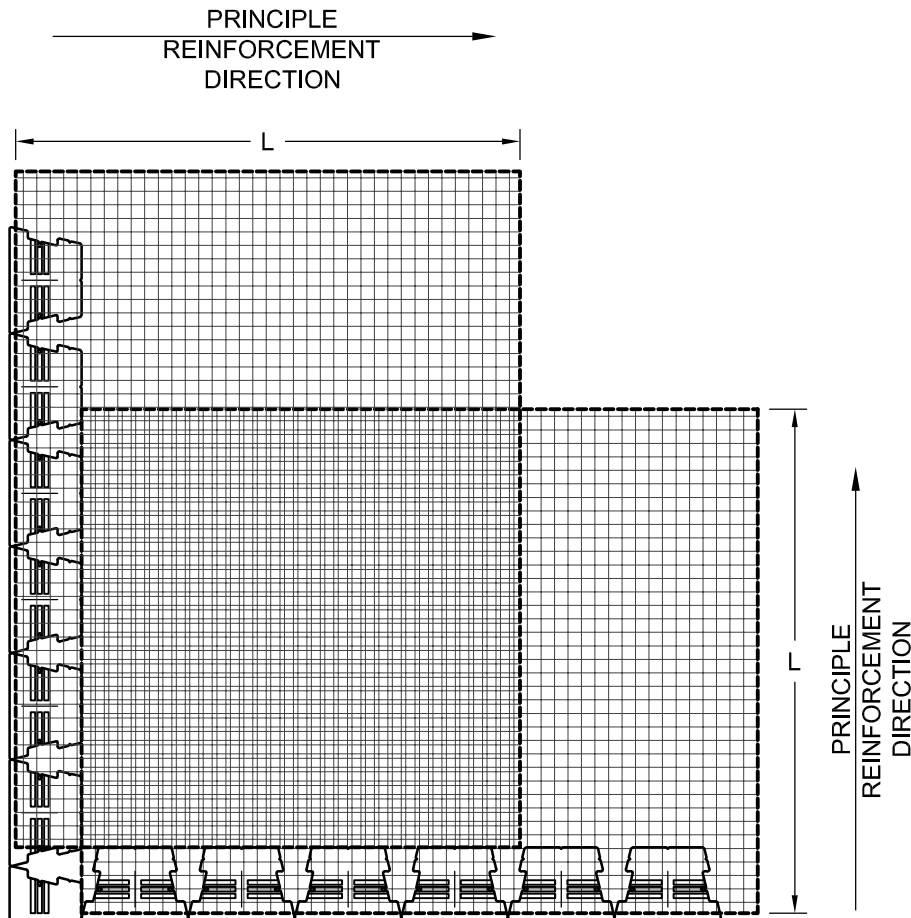

**NOTE:**  
 USE ADHESIVE ON EXPOSED PARTIAL UNITS.  
 CUT UNITS (X) AS NEEDED TO MAINTAIN RUNNING BOND.

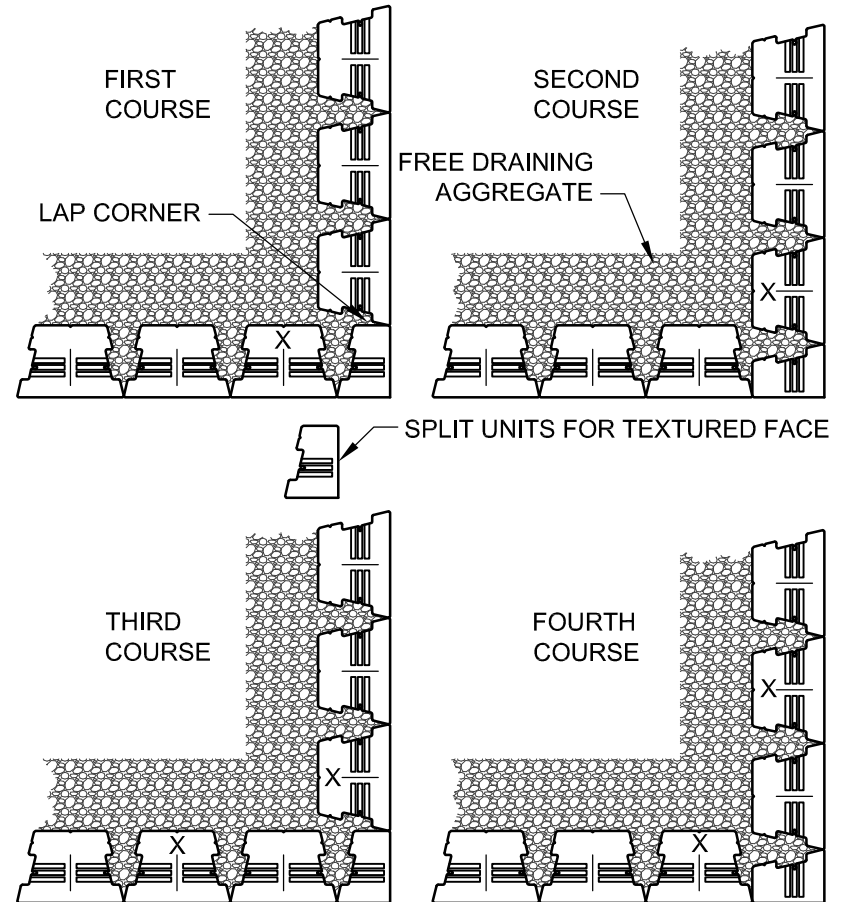

© 2017 Anchor Wall Engineering, LLC  
 © and ™ Anchor Wall Systems, Inc.  
[www.anchorwall.com](http://www.anchorwall.com)

This drawing is for illustrative purposes only and should not be used for construction without the signature of a registered professional engineer.

## Sterling™ Retaining Wall System

### Outside Corners

Scale:	Drawn by:
3/8" = 1'-0"	SB
Date:	Drawing number:
10/11/2017	SRST29